

Performance Curve

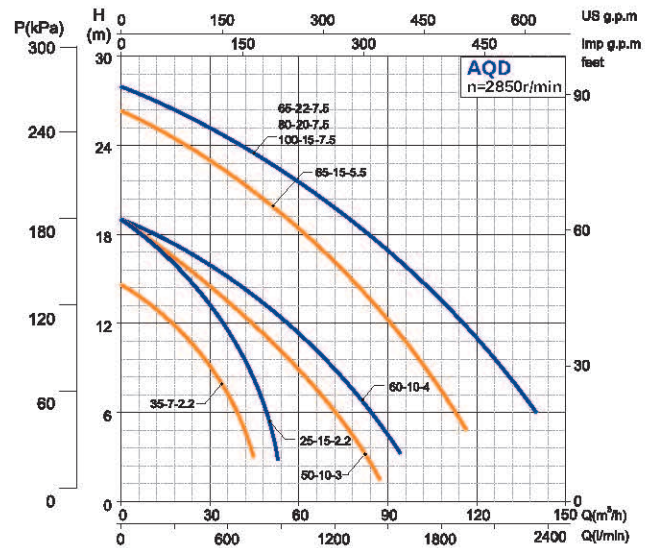
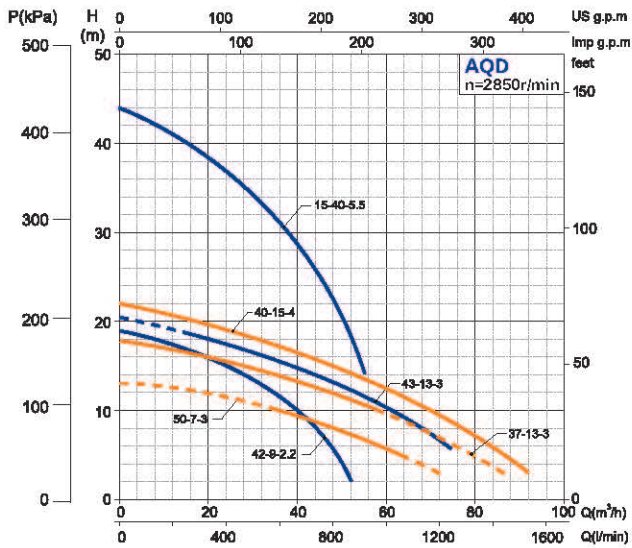
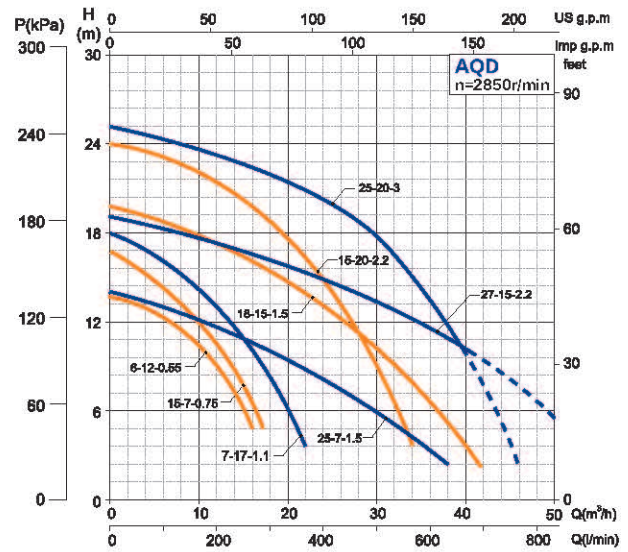
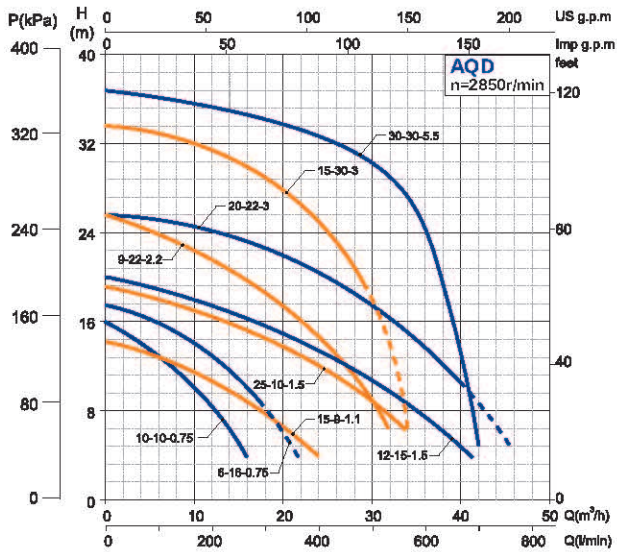

Model		Power		Rate Current (A)	Solids Passage (mm)	Max. Flow (m ³ /h)	Max. Head (m)	Head Range (m)	Cable line (m)	Dim.mm (L×W×H)	G.W (kg)	20' Loading Qty. (pcs)
Single-Phase	Three-Phase	kW	HP									
AQD6-12-0.55	-	0.55	0.75	4.1	20	17.5	15	14~0	3*0.75-8	470x250x235	20	1150
AQD6-16-0.75	-	0.75	1	5.2	20	22	19	18~5	3*0.75-8	470x250x235	22	1150
AQD6-16-0.75F	-	0.75	1	5.2	20	22	19	18~5	3*0.75-8	470x250x235	22	1150
AQD10-10-0.75	-	0.75	1	5.2	20	24	15	15~0	3*0.75-8	520x210x275	29	968
AQD7-17-1.1	-	1.1	1.5	7.3	20	19	21	20~3	3*1-8	451x245x172	27	1150
AQD15-9-1.1	-	1.1	1.5	7.3	20	25	14	14~0	3*1-8	540x240x280	32	968
AQD6-12-0.55F	-	0.55	0.75	4.1	20	17.5	15	14~0	3*0.75-8	470x250x235	20	1150
-	AQ6-16-0.75	0.75	1	2	20	22	19	18~8	4*0.75-8	470x250x235	20	968
-	AQ10-10-0.75	0.75	1	2	20	24	15	15~0	4*0.75-8	540x240x280	31	768
-	AQ15-7-0.75	0.75	1	2	20	17	17	17~0	4*0.75-8	540x240x280	32	768
-	AQ7-17-1.1	1.1	1.5	2.7	20	19	21	20~3	4*0.75-8	451x245x172	27	768
-	AQ15-9-1.1	1.1	1.5	2.7	20	25	14	14~0	4*0.75-8	540x240x280	32	768
-	AQ12-15-1.5	1.5	2	3.6	20	34	20	20~0	4*0.75-15	610x260x308	40	567
-	AQ18-15-1.5	1.5	2	3.6	20	47	19	20~0	4*0.75-15	610x260x308	45	567
-	AQ25-10-1.5	1.5	2	3.6	25	42	15	19~0	4*0.75-8	610x260x308	42	567
-	AQ25-7-1.5	1.5	2	3.6	25	40	14	14~0	4*0.75-8	610x260x308	39	567
-	AQ9-22-2.2	2.2	3	5.1	20	29	25	26~0	4*1-15	635x260x348	47	486
-	AQ15-20-2.2	2.2	3	5.1	20	35	25	24~0	4*1-15	635x260x348	47.7	486
-	AQ25-15-2.2	2.2	3	5.1	20	60	20	20~0	4*1-15	635x260x348	50	486
-	AQ27-15-2.2	2.2	3	5.1	28	62	21	19~5	4*1-15	635x260x348	50	486
-	AQ35-7-2.2	2.2	3	5.1	30	50	15	15~0	4*1-8	635x260x348	50	486
-	AQ42-9-2.2	2.2	3	5.1	25	60	16	19~0	4*1-8	655x270x328	50	504
-	AQ15-30-3	3	4	6.7	25	31	34	34~20	3*1.5+1*1-15	635x260x348	50	486
-	AQ20-22-3	3	4	6.7	25	45	27	26~10	3*1.5+1*1-15	635x260x348	54	486
-	AQ25-20-3	3	4	6.7	25	48	25	25~10	3*1.5+1*1-15	635x260x348	54	486
-	AQ37-13-3	3	4	6.7	25	77	20	18~0	3*1.5+1*1-8	720x320x390	56.5	336
-	AQ43-13-3	3	4	6.7	25	82	18.5	18~0	3*1.5+1*1-8	700x310x370	68	336
-	AQ50-7-3	3	4	6.7	32	72	13	13~0	3*1.5+1*1-8	720x320x390	62	336
-	AQ50-10-3	3	4	6.7	25	84	19	19~0	3*1.5+1*1-8	720x320x390	62	336
-	AQ40-15-4	4	5.5	8.8	25	70	22	22~0	3*1.5+1*1-8	755x325x395	80	324
-	AQ60-10-4	4	5.5	8.8	43	92	18	18~0	3*1.5+1*1-8	800x335x395	83	294
-	AQ15-40-5.5	5.5	7.5	11.7	25	52	42.5	42.5~0	3*1.5+1*1 ☆ -8	755x325x395	85	324
-	AQ30-30-5.5	5.5	7.5	11.7	25	39	37	37~0	3*1.5+1*1 ☆ -15	800x320x380	88	294
-	AQ65-15-5.5	5.5	7.5	11.7	30	110	25	26~0	3*1.5+1*1 ☆ -8	1050x345x325	103	175
-	AQ65-20-7.5	7.5	10	15.7	30	130	30	27~0	3*6+1*4 ☆ -8	733x498x290	113	120
-	AQ65-22-7.5	7.5	10	15.7	30	130	30	30~0	3*1.5+1*1 ☆ -15	870x400x470	130	120
-	AQ80-20-7.5	7.5	10	15.7	30	130	30	30~0	3*1.5+1*1 ☆ -8	870x400x470	130	120
-	AQ100-15-7.5	7.5	10	15.7	30	130	30	30~0	3*1.5+1*1 ☆ -8	870x400x470	130	120
-	AQ6-16-0.75(415V/50Hz)	0.75	1	1.8	20	22	19	18~5	4*0.75-8	470x250x235	21	1150
-	AQ18-15-1.5(415V/50Hz)	1.5	2	3.3	20	47	19	19~0	4*0.75-15	610x260x308	45	567
-	AQ25-15-2.2(415V/50Hz)	2.2	3	4.7	20	60	20	20~0	4*1-15	635x260x348	50	486
-	AQ25-20-3(415V/50Hz)	3	4	6.1	25	48	25	25~10	3*1.5+1*1-15	635x260x348	54	486
-	AQ50-10-3(415V/50Hz)	3	4	6.1	25	84	19	19~0	3*1.5+1*1-8	720x320x390	62	336
-	AQ40-15-4(415V/50Hz)	4	5.5	8.1	25	70	22	22~0	3*1.5+1*1-8	755x325x395	80	324
-	AQ60-10-4(415V/50Hz)	4	5.5	8.1	43	92	18	18~0	3*1.5+1*1-8	800x335x395	83	324
-	AQ65-15-5.5(415V/50Hz)	5.5	7.5	10.7	30	110	25	26~0	3*1.5+1*1 ☆ -8	1050x345x325	103	175
-	AQ100-10-7.5(415V/50Hz)	7.5	10	14.4	30	140	21	27~0	3*2.5+1*1.5-8	870x430x520	131	120

Centrifugal pumps are not recommended to be used less than the lift range.
 Note: Single-Phase:AQD6-12-0.55/AQD6-16-0.75/AQD6-16-0.75F is the honeycomb carton;
 Three-Phase:AQ6-16-0.75 is the honeycomb carton.The others are wooden cases.

Components & Materials

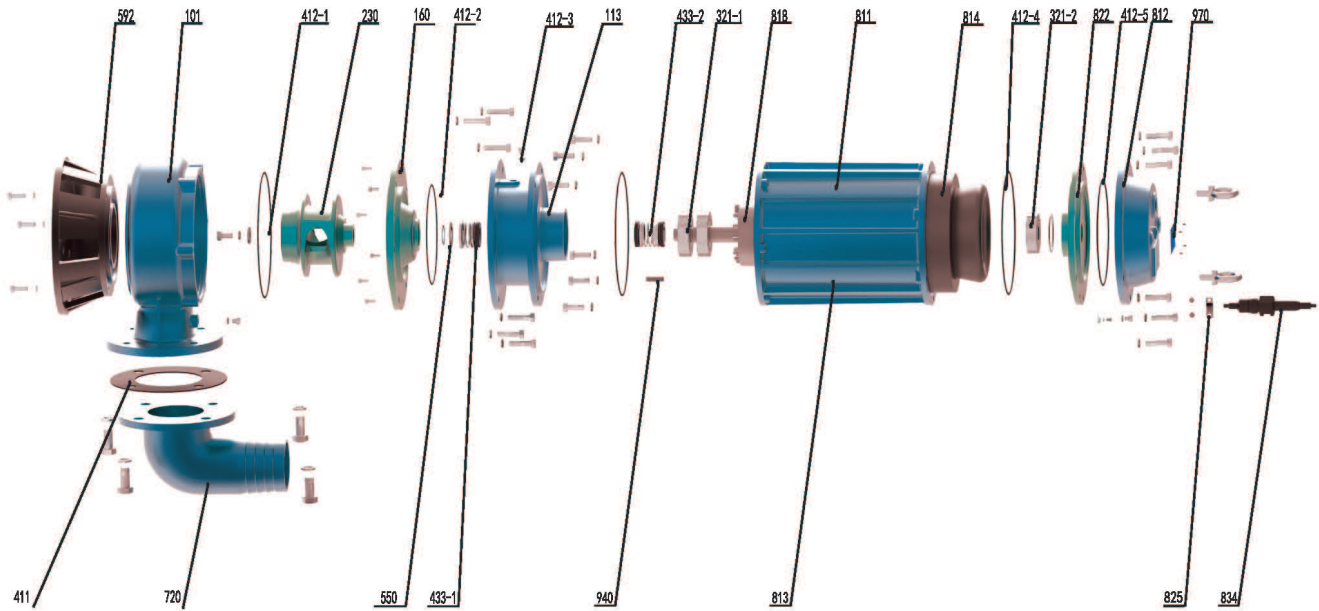

No.	Part name	No.	Part name	No.	Part name
101	Pump body	412-3	O-ring	812	Head cover
113	Oil chamber cover	412-4	O-ring	814	Stator core with winding
160	Oil chamber cover	412-5	O-ring	818	Rotor
230	Impeller	433-1	Mechanical seal	822	Upper bearing block
321-1	Deep groove ball bearing	433-2	Mechanical seal	825	Cable pressing plate
321-2	Deep groove ball bearing	550	Mechanical seal ring	834	Cable sheath
411	Rubber washer	592	Base	940	Flat key
412-1	O-ring	720	Outlet joint	970	Nameplate
412-2	O-ring	811	Casing		

Dimensions & Weight

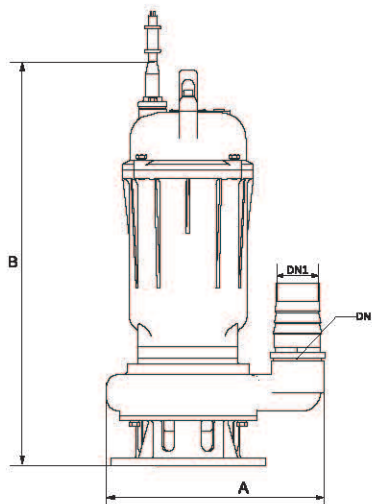
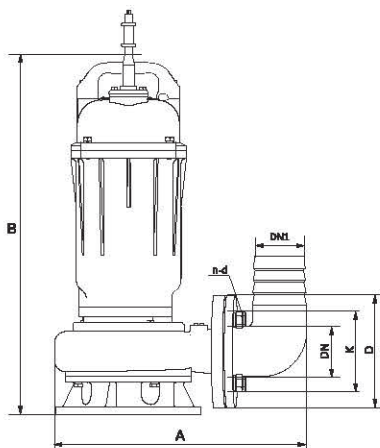

Model		Dim.(mm)							N.W. (kg)
Single-Phase	Three-Phase	A	B	DN1	DN	D	K	n-d	
AQD6-12-0.55	-	245	435	2"					17.5/19
AQD6-16-0.75	-	245	440	2"	G1½ Pipe Thread				20/21
AQD6-16-0.75F	-	245	440	2"					20/21
AQD10-10-0.75	-	312	440	2"	2"	140	110	4-M12	26
AQD7-17-1.1	-	245	451	2"	G1½ Pipe Thread				28
AQD15-9-1.1	-	285	454	2"	2"	140	110	4-M12	29
AQD6-12-0.55F	-	245	442	2"	G1½ Pipe Thread				17.5/19
-	AQ6-16-0.75	245	442	2"	G1½ Pipe Thread				20
-	AQ10-10-0.75	312	440	2"	2"	140	110	4-M12	26
-	AQ15-7-0.75	312	440	2"					26
-	AQ7-17-1.1	245	451	2"	G1½ Pipe Thread				28
-	AQ15-9-1.1	316	468	2"	2"	140	110	4-M12	29
-	AQ12-15-1.5	340	540	2"	2"	140	110	4-M12	36
-	AQ18-15-1.5	347	540	2"	2"	140	110	4-M12	41
-	AQ25-10-1.5	331	534	2"	2"	140	110	4-M12	38
-	AQ25-7-1.5	344	498	2.5"	2.5"	160	130	4-M12	35
-	AQ9-22-2.2	326	556	2"	2"	140	110	4-M12	42
-	AQ15-20-2.2	341	556	2"	2"	140	110	4-M12	44
-	AQ25-15-2.2	384	568	2.5"	2.5"	160	130	4-M12	45
-	AQ27-15-2.2	367	568	2.5"	2.5"	160	130	4-M12	45
-	AQ35-7-2.2	384	568	2.5"	2.5"	160	130	4-M12	45
-	AQ42-9-2.2	376	594	2.5"	2.5"	160	130	4-M12	47
-	AQ15-30-3	362	551	2"	2"	140	110	4-M12	48
-	AQ20-22-3	360	554	2.5"	2.5"	160	130	4-M12	49
-	AQ25-20-3	360	554	2.5"	2.5"	160	130	4-M12	49
-	AQ37-13-3	399	602	2.5"	2.5"	160	130	4-M12	61
-	AQ43-13-3	419	602	3"	3"	190	150	4-M16	61
-	AQ50-7-3	419	602	3"	3"	190	150	4-M16	61
-	AQ50-10-3	419	602	3"	3"	190	150	4-M16	55
-	AQ40-15-4	371	661	3"	3"	190	150	4-M16	73
-	AQ60-10-4	452	704	4"	4"	210	170	4-M16	75
-	AQ15-40-5.5	411	745	2"	2"	140	110	4-M12	78
-	AQ30-30-5.5	390	783	3"	3"	190	150	4-M16	80
-	AQ65-15-5.5	452	826	4"	4"	210	170	4-M16	93
-	AQ65-25-7.5	495	730	4"	4"	210	170	4-M16	117
-	AQ80-20-7.5	495	730	4"	4"	210	170	4-M16	117
-	AQ100-15-7.5	495	730	4"	4"	210	170	4-M16	117
-	AQ6-16-0.75(415V/50Hz)	247	438	2"	G1½ Pipe Thread				20
-	AQ18-15-1.5(415V/50Hz)	347	540	2"	2"	140	110	4-M12	41
-	AQ25-15-2.2(415V/50Hz)	384	568	2.5"	2.5"	160	130	4-M12	45
-	AQ25-20-3(415V/50Hz)	360	554	2.5"	2.5"	160	130	4-M12	49
-	AQ50-10-3(415V/50Hz)	419	602	3"	3"	190	150	4-M16	55
-	AQ40-15-4(415V/50Hz)	371	661	3"	3"	190	150	4-M16	73
-	AQ60-10-4(415V/50Hz)	371	704	4"	4"	210	170	4-M16	75
-	AQ65-15-5.5(415V/50Hz)	452	826	4"	4"	210	170	4-M16	93
-	AQ100-10-7.5(415V/50Hz)	562	733	4"	4"	210	170	4-M16	118